

Rangoonwala Foundation (India) Trust

Trust Reg. No.: E-20860 - Mumbai

RF(I)T/Ne/C/ Dec 07

December 24, 2007

Mr. P.A. Inamdar
Haji Gulam Mohammed Azam Education Trust
2390, K.B. Hidayatullah Road, Azam Campus
Camp,
PUNE 411 001.

Sub: Copy of Agreement for M.A Rangoonwala College of Hospitality Studies & Research

Dear Mr. Inamdar,

Please find enclosed herewith the signed Copy of Agreement for M.A. Rangoonwala College of Hospitality Studies & Research duly notarized.

Regards,

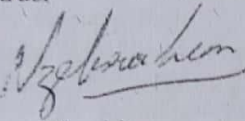

Nisreen Ebrahim
Managing Trustee

Encl: as above

| |
|---------------------------|
| M.C.E. SOCIETY, PUNE |
| INWARD NO.: <u>1624</u> |
| Date :- <u>26/12/07</u> |
| Sign.: <u>[Signature]</u> |

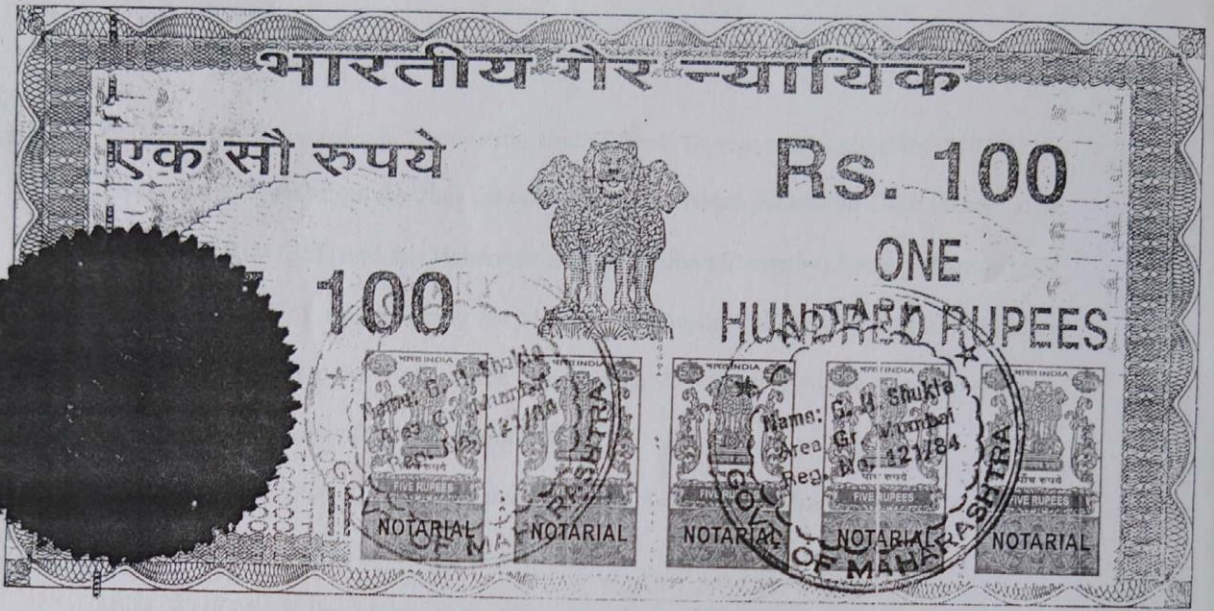

महाराष्ट्र MAHARASHTRA

Stamp Vendor
Mrs. Yogini M. Sakunde
 830, Bhawani Peth,
 Behind Bhawani Mata Mandir, Pune-42.
 L. No. HLB/1221/2001

अनु क्र. ७८८८ दिनांक १०/१०/०८ १००/-
 नाव प्र. श्री ई. सोसायटी
 पत्ता २३९०-ब. खान बहादुर हिदायतुल्ला रोड पुणे
 रुपये किंमत रॉटिदा

AS 857013

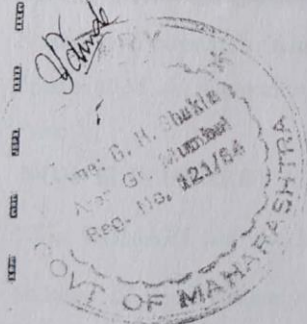

This agreement is made on

Between

Rangoonwala Foundation (India) Trust
 85 Atlanta, Nariman Point, Mumbai 400 021

Of the first part

And

Haji Gulam Mohammed Azam Education Trust, Pune

&

The Maharashtra Cosmopolitan Education Society, Pune

Both at

2390-B Khan Bahadur Hidayatullah Road Azam Campus, New Modikhana,
 Pune - 411 001

Of the second part

PROJECT TITLE : M.A. Rangoonwala College of Hospitality Studies and Research

PROJECT NUMBER: HGMAET/ Hospitality Studies & Research College/RF(I)T-VII

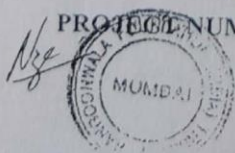

P.A. Inamdar
 President
 M. C. E. Society, Pune-1



Whereas the Rangoonwala Foundation (India) Trust (herein after called the RF(I)T has received a proposal from the Haji Gulam Mohammed Azam Education Trust (herein after called the HGMAET) and the Maharashtra Cosmopolitan Education Society (here in after called the MCES) for establishing the M.A. Rangoonwala College of Hospitality Studies and Research. Approved by the State Government & Affiliated to the Pune University, offering the three years full time degree course,

AND WHEREAS the RF(I)T has agreed to contribute a sum of Indian Rupee 15 Million (INR 15,000,000 only) for the above purpose.

AND WHEREAS the college has been named the **M.A. Rangoonwala College of Hospitality Studies and Research**

AND WHEREAS the HGMAET owns approximately 24 acres land at 2390-B, Khan Bahadur Hidayatullah Road, Azam Campus, New Modikhana, Pune 411 001; of which it has exclusively earmarked 1 acre land for the M.A. Rangoonwala College of Hospitality Studies and Research (**Annexure I:** Layout of Azam Camus, Building Plan and related details of M. A. Rangoonwala College of Hospitality studies and Research at HGMAET, Pune.

NOW IT IS HEREBY AGREED AS FOLLOWS:

1. The HGMAET and the MCES have undertaken the full responsibility to maintain the building of approximately 30,000 square feet constructed by them as per University norms partly with RF(I)T funding (**Annexure II:** List of Building for the M.A. Rangoonwala College of Hospitality studies and Research at HGMAET, Pune.), equipment procured and all facilities including the requisite human resources require for the M.A. Rangoonwala College of Hospitality Studies and Research as per the statutory norms as well as what steps/actions the RF(I)T deems necessary for the M. A. Rangoonwala College of Hospitality Studies and Research to continue to function as an educational institute of excellence.

P.A. Inamdar
President
M.C.E. Society, Pune

Chairman

Haji Gulam Mohammed Azam Education Trust

As



2. The HGMAET and MCES have agreed to incur all recurring and no-recurring expenses to expand, maintain and appropriately and adequately equip materially and with qualified staff, the M.A. Rangoonwala College of Hospitality Studies and Research as per the guidelines specified by the state cost and other such regulatory bodies at all times.
3. The HGMAET has undertaken the responsibility for the use of the funds as well as interest accrued thereon. for the purpose for which they were received from the RF (I) T i.e. for building construction, equipment furniture and fixtures only. (**Annexure III:** Line item wise Budget, detailing the use of RF (I) T funding. & **Annexure IV :** List of equipment, furniture, & fixtures) in conformity with the Govt. of India's legal requirements for the utilization of foreign funds.
4. The RF (I) T has provided this grant without discrimination or bias on grounds of gender, religion, race or caste or otherwise and expects that its funds and facilities thus created be utilized by HGMAET and MCES in the same way.
5. The HGMAET will maintain a record of all capital items created and purchased with the project funds and will not sell, transfer or otherwise dispose off, or make any change in use of moveable or immovable assets created by this grant without taking the prior written approval of the RF (I) T. These assets will not be used for purposes other than the activities of the M.A. Rangoonwala College of Hospitality Studies and Research, unless agreed to by the RF (I)T in writing.

ACCOUNTING AND REPORTING REQUIREMENTS

- 6 a) The HGMAET will submit to the RF(I)T six monthly progress reports of the M.A. Rangoonwala College of Hospitality Studies and Research, detailing the activities undertaken in perpetuity. In addition, the reports will detail the RF(I)T fund utilization against agreed Budget heads and any other financial information the RF(I)T may call for.

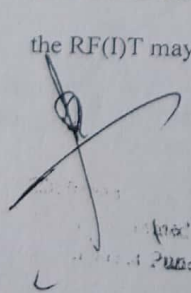
P.A. Namdar
 President
 M.C.E. Society, Pune-1



The reporting requirement of the RF(I)T will be intimated under separate cover and may change from time to time as required by the RF(I)T.

b) The schedule for reports every calendar year will be as follows:

| 1 st Six Monthly | 2 nd Six Monthly |
|-----------------------------|-----------------------------|
| April | October |

7. a) in addition to the above, the HGMAET and the MCES will submit to the RF(I)T at the end of each financial year, audited and thus certified accounts (by independent qualified Chartered Accountant) of the M.A. Rangoonwala College of Hospitality Studies and Research as well as the HGMAET and MCES, certified by it's Director or chief functionary as the case may be.

b) Audit fees will be paid by the HGMAET and MCES, for their organizations..

c) The final audited accounts will be made available to the RF(I)T within 90 days of the end of the HGMAET and MCES's financial year, which is from April to the subsequent March of the Christian calendar year.

ACKNOWLEDGEMENT OF RF(I), HGMAET AND MCES:

8 a) The HGMAET and the MCES will ensure that all moveable and immoveable assets, publications, documents, stationery and references to the M.A. Rangoonwala College of Hospitality Studies and Research, including the HGMAET and the MCES Annual Reports, acknowledges the support of the RF(I)T.

b) Likewise, the RF(I)T will acknowledge the HGMAET and the MCES in any reference, documents and publications made by it regarding the M.A. Rangoonwala College of Hospitality Studies and Research.

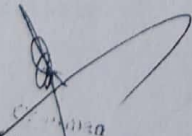
Haji Sahib Mohammed
Azam Education Trust Pune-1

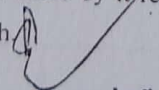
P. A. Inamdar
President
M.C.E. Society, Pune-1



MONITORING AND EVALUATION:

9) a) The functioning and the finances of the M.A. Rangoonwala College of Hospitality Studies and Research will be periodically monitored by the authorized representatives of the RF(I)T.

b) The RF(I)T's representatives will visit the HGMAET campus and the M.A. Rangoonwala College of Hospitality Studies and Research in particular from time to time as part of the monitoring and evaluation process. The HGMAET and MCES will cooperate in this process by sharing information, making available all records and data relating to the respective organizations and particularly the M.A. Rangoonwala College of Hospitality Studies and Research in the formats desired by the RF(I)T for their scrutiny and assessment.

c) If desired, the RF(I)T may call for an independent external evaluation of the College. The costs for this will be borne by the RF(I)T.

d) The RF(I)T representative as designed from time to time, will liaise with the HGMAET and the MCES for all programmatic and administrative matters related to the M.A. Rangoonwala Hotel Management College.

FUND DISBURSEMENT SCHEDULE:

10. The RF(I)T will disburse its contribution to the HGMAET towards the M.A. Rangoonwala Hotel Management College as follows:

| Amount INR | Scheduled disbursement | Duration |
|-----------------|--|-------------------|
| INR 2500000 | After signing of agreement By both parties | Up to March 2008 |
| INR 2500000 | April 2008 | April-sept.2008 |
| INR 2500000 | October 2008 | Oct.08 – Mar 09 |
| INR 2500000 | April 2009 | April – Sept 2009 |
| INR 2500000 | October 2009 | Oct.09-Mar. 10 |
| INR 2500000 | April 2010 | April – Sept 2010 |
| INR 15,00,00,00 | | |

M.C.E. Pune-1

Chairman
M.A. Rangoonwala Hotel Management College
Education Trust Pune-1



Installment release by the RF(I)T will be subject to submission of utilization statements for RF(I)T funds as well as MCES and HGMAET adhering to conditions and reporting requirement agreed to herein.

STATUTORY REQUIREMENTS UNDER VARIOUS LAWS IN INDIA:

11. a) The HGMAET and the MCES will be responsible for complying with all Indian Central and State Government, affiliated University and stipulations, Acts, Rules and Regulations that are applicable to it.
- b) The HGMAET & MCES will comply with all laws rules and regulations pertaining to the use of foreign funds that may be enacted or issued by the Government of India or authorities designated by it from time to time. The HGMAET and the MCES will cooperate with the RF(I)T to enable it to meet any of its mandatory regulatory obligations pertaining to the funds disbursed for the M.A. Rangoonwala College of Hospitality Studies and Research.
- c) The HGMAET and the MCES will comply with all laws, and all relevant regulations applicable to it.
- d) The responsibility of complying with labor laws as well as any regulatory or contractual obligations towards its employees and / or project staff; suppliers, vendors, contractors will be that of the HGMAET and MCES.
- e) The RF (I) T is hereby indemnified by the HGMAET and the MCES against any infringement of the law by the HGMAET or the MCES or any action, suits, Damages, claims by anyone whatsoever against the HGMAET and MCES
- f) The RF (I) T is hereby indemnified by the HGMAET and the MCES against any damage or injury caused as a result of misuse of equipment, malfunctioning of equipment or decisions related to its procurement by the HGMAET and / or the MCES with RF(I)T funding.

Chairman
 Muhammad Mohammed
 Education Trust

P.A. Inamdar
 President
 M.C.E. Society, Pune-1



12 The HGMAET and MCES will be responsible for management practices that are transparent and meet legal and regulatory standards for the M.A. Rangoonwala College of Hospitality Studies and Research, as well as all matters pertaining to administrative and admission procedures.

SPECIAL CONDITIONS:

13 The RF (I)T has the right to appoint two representatives on the Local Managing Committee and / or any other body that oversees the management functions and decision making of the M.A. Rangoonwala College of Hospitality Studies and Research.

14. The HGMAET and the MCES will convene the meeting of the Local Managing Committee and/ or any other that oversees the management functions and decision making body at least once in every six month after six monthly reports have been submitted to the RF (I)T.

15. The RF (I)T may requisition a meeting of the Local Managing Committee and/ or any other body that oversees the management functions and decision making by giving one month's notice in writing to the correspondence address mentioned in this agreement.

16. It is specifically agreed that the RF(I)T is entitled to make appointments as representatives under the clause No. 13 irrespective of their gender, caste, race religion or otherwise and the HGMAET and the MCES are bound not to raise any objection on the ground of the gender, caste, race, religion or otherwise in respect of the aforesaid representatives.



[Signature]
 P. A. Inamdar
 President
 M.C.E. Society, Pune-1

[Signature]
 P.A. Inamdar
 President
 M.C.E. Society, Pune-1

17. The MCES and HGMAET agree to admit six student applicants recommended by the RF(I)T, through the RF(I)T duly authorized representative; in the first year Hotel Management degree course at the start of every academic year, irrespective of their gender, caste, race, religion or otherwise. The RF(I)T's recommended applicants will pay an annual all inclusive course fee of INR 15,000 per year. The HGMAET/MCES are bound not to raise any objections on the ground of gender, caste, race, religion or otherwise and in terms of fees to be paid in respect of the aforesaid recommended applications.

AMENDMENTS:

18 This Agreement can altered only by mutual consent in writing.

19. PROPER MANAGEMENT BY THE HAGMAET, MCES AND THE
M.A. RANGOONWALA HOTEL MANAGEMENT COLLEGE

a) In the RF(I)T's sole opinion if the requirements/intents/conditions of this Agreement are violated or not adhered to in letter and spirit, the RF(I)T will given written notice to HGMAET and MCES to remedy to the violation and require them to take remedial action within 30 days from the receipt of the notice.

Should the violation not be rectified or the remedial action not be taken within this time, this Agreement will be terminated by the RF(I)T and the name M.A. Rangoonwala disassociated from the College of Hospitality Studies and Research.

b) If, however, for good reasons given to the RF (I)T in writing, some more time is required, the RF(I)T may in its discretion extend the 30-days time limit.



P.A. Inamdar
President
M.C.E. Society, Pune-1

Chairman
M.C.E. Society, Pune-1
M.A. Rangoonwala Education Trust Pune-1

20. **ARBITRATION:**

Any questions, dispute of difference between the parties to this Agreement which cannot be amicably settled within 30 days, shall be finally settled by appeal to the concerned appropriate authority for the time being or settled by arbitration, in accordance to the Arbitration and Conciliation Act, 1966, by three arbitrators; in which case the proceedings shall take place and the award will be given in Mumba.

21. **CORRESPONDENCE ADDRESS:**

The correspondence address for all matters relating to this Agreement will be:

- **For the HGMAET and MCES**

2390-b Khan Bahadur Hidayatullah Road,
Azam Campus, New Modikhana, Pune 411 001, India.

- **For the Rangoonwala Foundation (India) Trust :**

C/o85, Atlanta, Nariman Point, Mumbai 400 021, India.

22 .Subject to Clause 18, this Agreement is entered to in perpetuity and will be binding on all present and future authorized representatives of each party is a signatory herein.

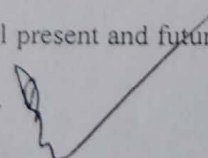
P.A. Inamdar
President
M.C.E. Society, Pune-1

Chairman
Rangoonwala Foundation (India) Trust





The above terms and conditions understood and accepted with Annexure I, II, III, IV, V. attached hereto and signed in triplicate, as well as stamped and initialed on all pages by authorized signatories of all parties.

1) Signed Sealed and delivered by the within named

Mr & Mrs NISREEN EBRAHIM

On behalf of RF (I)T

Signature [Handwritten Signature]

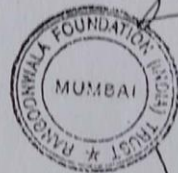

2) Signed Sealed and delivered by the within named

Mr M.A.Peerbhoy On behalf of HGMAT Pune

signature [Handwritten Signature]
Chairman
HGMAT Pune
Rangonwala Education Trust Pune-I

3) Signed Sealed and delivered by the within named

Mr P.A.Inamdar On behalf of MCES Pune

[Handwritten Signature]



Signature P.A.Inamdar
President
M.C.E.Society, Pune

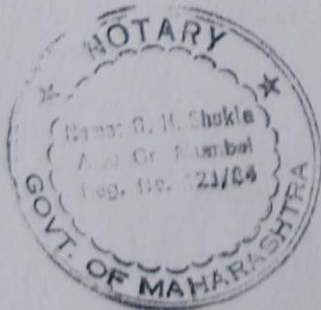

ATTESTED TRUE COPY

[Handwritten Signature]
G. H. SHUKLA
NOTARY GREATER MUMBAI
Jagdamba Bhavan Ground Floor,
Ganpatrao Kadam Marg Lower Parel,
MUMBAI - 400 013.

22 DEC 2007

10. Staff Room.

| Particulars | Amount |
|-------------------------|------------|
| 1. Tables | |
| 2. Chairs | |
| 3. Cupboards | |
| 4. Mini fridge | |
| 5. Electrical Fittings. | |
| Total (A10) | 1,40,000/- |

11. Principals Office

| Particulars | Amount |
|--------------------------|------------|
| 1. Interior | |
| 2. Furniture & Fixtures. | |
| Total (A11) | 6,80,000/- |

12. Administration Office

| Particulars | Amount |
|--------------------------|------------|
| 1. Interior | |
| 2. Furniture & Fixtures. | |
| Total (A12) | 2,10,000/- |

13. Examination Room

| Particulars | Amount |
|--------------------------|----------|
| 1. Cupboards | |
| 2. Racks | |
| 3. Furniture & Fixtures. | |
| Total(A13) | 50,000/- |

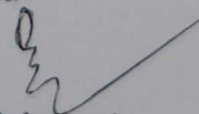

P.A. Inamdar
President
M.C.E. Society, Pune-1

ANNEXURE



Annexure I: Layout of Azam Campus, Building plan and related details of M.A. Rangoonwala College of Hospitality Studies and Research at HGMAET, Pune.

Annexure II: List of Building for the M.A. Rangoonwala College of Hospitality studies and Research at HGMAET, Pune.

Annexure III: Line item wise Budget, detailing the use of RF (I) T funding. on a yearly October – September cycle up to April 2010.

Annexure IV: List of Equipment, furniture – fixture and other facilities required for the M.A. Rangoonwala College of Hospitality Studies and Research.

Annexure V: Human Resources requirement for the M.A. Rangoonwala College of Hospitality and Research.



P.A. Inamdar
President
M.C.E. Society, Pune-1



14. Library

| Particulars | Amount |
|---|-------------|
| 1. Library Tables | |
| 2. Chairs | |
| 3. Xerox Machine | |
| 4. Cupboards | |
| 5. Racks (Newspaper & Magazines) | |
| 6. 10 Computers with internet facility. | |
| 7. Furniture & Fixtures. | |
| Total (A14) | 10,00,000/- |

15. Students Common Area

| Particulars | Amount |
|---|------------|
| 1. Cloak Room male | |
| 2. Cloak Room female | |
| 3. Water cooler | |
| 4. Students Recreation Room (Table tennis, chess, carom etc) | |
| 5. Furniture & Fixtures. | |
| Total (A15) | 1,50,000/- |

TOTAL

(A1+A2+A3+A4+A5+A6+A7+
A8+A9+A10+A11+A12+A13+A14+A15)

₹8,10,000/-

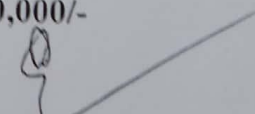
P.A. Inamdar
President
M.C.E. Society, Pune-1



M.C.E. Society, Pune-1
C. No. 1, Post 24, 40-1

ANNEXURE I

Campus lay out plan showing college of
Hospitality Studies & Research





ANNEXURE NO. II

Floor wise Building Plan of the College of
Hospitality Studies & Research.

Annexure II

ARCHITECT,
INTERIOR DESIGNER & VALUER



RIYAZ MULLA

6, SHAHEEN BLDG, AZAM CAMPUS, 2390,
K.B.HIDAYATULLA ROAD,
CAMP, OPP. DHOBIHAT,
NEAR UNANI HOSPITAL GATE,
PUNE-411 001. ☎ : 2644 1568.
Mobile : 9422004934
E-mail : promptarch@yahoo.co.in
archm32@hotmail.com

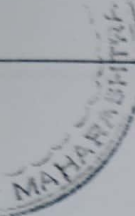

AREA STATEMENT

FOR COLLEGE BUILDING OF HOSPITALITY STUDIES
AND RESEARCH CENTRE

| | | |
|------------------|---|----------------|
| * BASEMENT FLOOR | = | 7213.00 SFT |
| * GROUND FLOOR | = | 7718.00 SFT |
| * FIRST FLOOR | = | 7718.00 SFT |
| * SECOND FLOOR | = | 7718.00 SFT |
| TOTAL AREA | | = 30367.00 SFT |

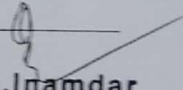
P.A. Inamdar
President
M.C.E. Society, Pune-1



Anexuro II (construction cost)

ARCHITECT,
OWNER, DESIGNER & VALUER



RIYAZ MULLA

6, SHAHEEN BLDG, AZAM CAMPUS, 2390,
K.B.HIDAYATULLA ROAD,
CAMP, OPP. DHOIGHAT,
NEAR UNANI HOSPITAL GATE,
PUNE-411 001. ☎ : 2644 1568.
Mobile : 9422004934
E-mail : promptarch@yahoo.co.in
archm32@hotmail.com

F. MAHARAJA

To Whom It May Concern

This to certify that the construction work of the College building of hospitality studies and research centre at Azam campus, Pune was completed on 31st July 2005, and the cost of construction is as follows:

| | | |
|----------------------------|---|--|
| Built up area | = | 30367.00 sft. |
| Cost of Construction | = | Rs 400 /- per sft. |
| Total Cost of Construction | = | Rs. 1,21,46,800/- (Rupees One Crore twenty one Lakh forty six thousand eight hundred only.) |

(RIYAZ MULLA)
ARCHITECT



Annexure II (Bldg Plan)

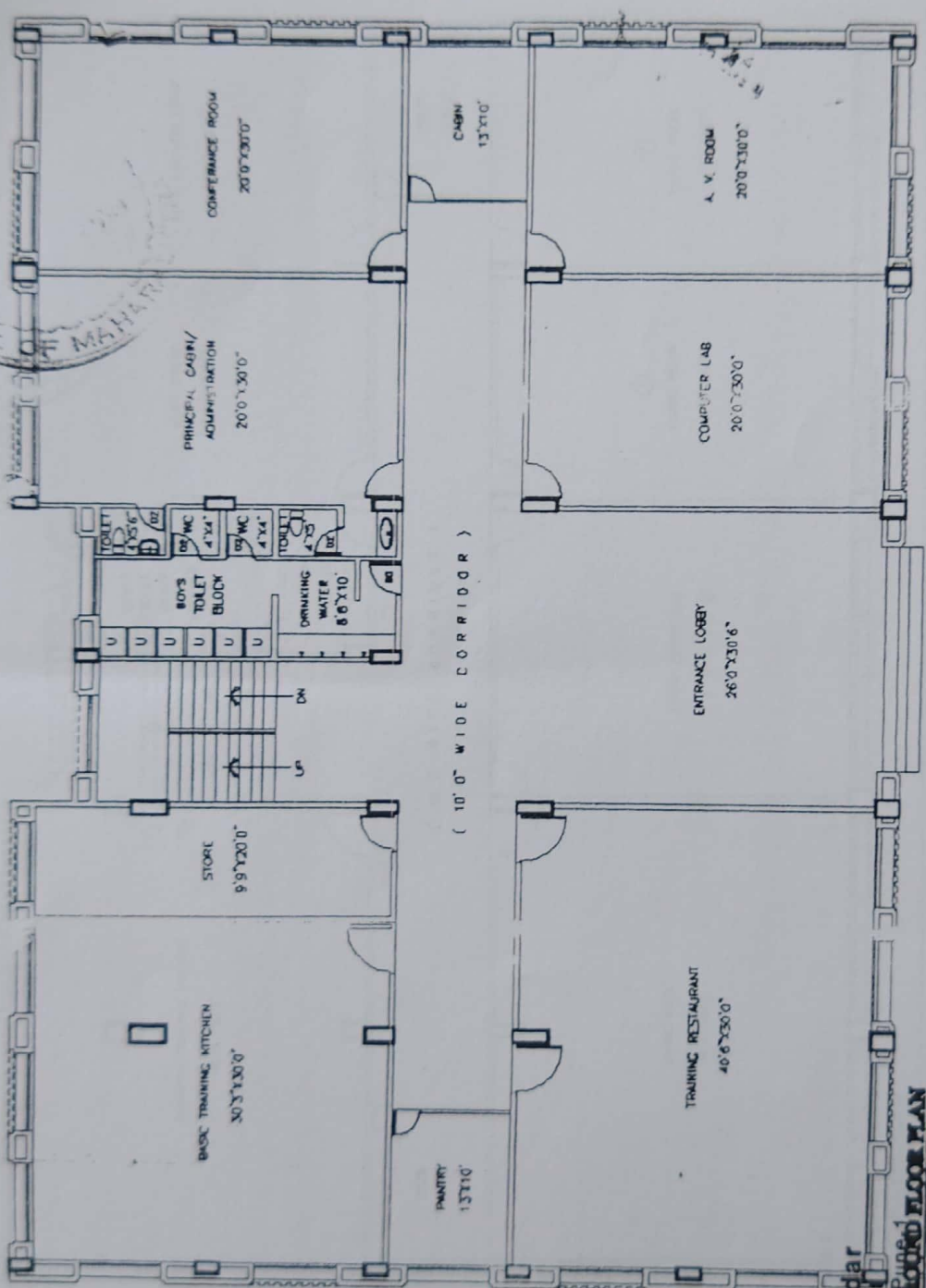

Annexure I



P.A. Inamdar
President
M.C.E. Society, Pune

GROUND FLOOR PLAN

PROPOSED M.C.E. SOCIETY'S INSTITUTE OF HOTEL
MANAGEMENT AND CATERING TECHNOLOGY AT
2390, K.B.HIDAYTULLA ROAD, AZAM CAMPUS, PUNE.



RIYAZ MULLA
Architects

| | |
|--|------------------|
| PROJECT HOTEL DESIGN & BUILD | DEALT SINCE |
| DESIGNED BY S. SHAMER & CO ARCHITECTS 200, VIKAS ROAD, NEW LAXMI NAGAR, NEW LAXMI NAGAR, CHENNAI 600 042 | DATE 02/04/03 |
| SCALE 1:100 | JOB 10000/72 |

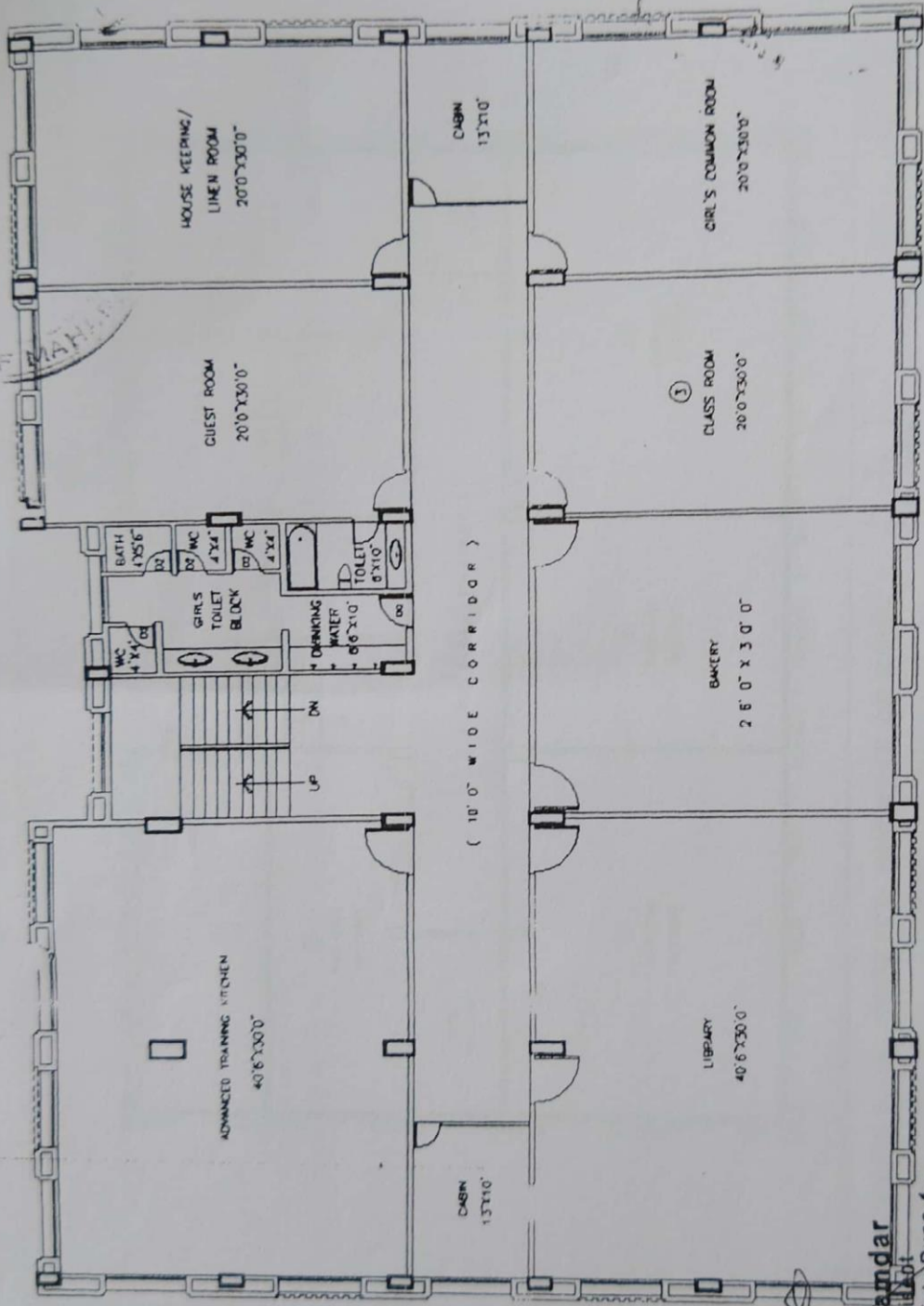

PROPOSED M.C.E. SOCIETY'S INSTITUTE OF HOTEL
 MANAGEMENT AND CATERING TECHNOLOGY AT
 2390, K.B.HIDAYTULLA JAD, AZAM CAMPUS, PUNE.

| | |
|-------------|----------|
| DEALT SHEET | DATE |
| | 01/06/05 |

MENTEL
 RITVIJAY DESAI & MURP
 23, SHANKAR BLDG. 2ND FLOOR
 101, PANDHARNAO
 NEW LONAR, ACHER, DIST.
 PUNE-411 001, INDIA. TEL: 2441 15 86.
 FAX: 2441 15 87. E-MAIL: mentel@mentel.com



RIYAZ MULLA

P.A. Inamdar
 President
 M.C.E. Society

GROUND FLOOR PLAN

**"EDUCATIONAL BUILDING"
BASEMENT FLOOR PLAN**

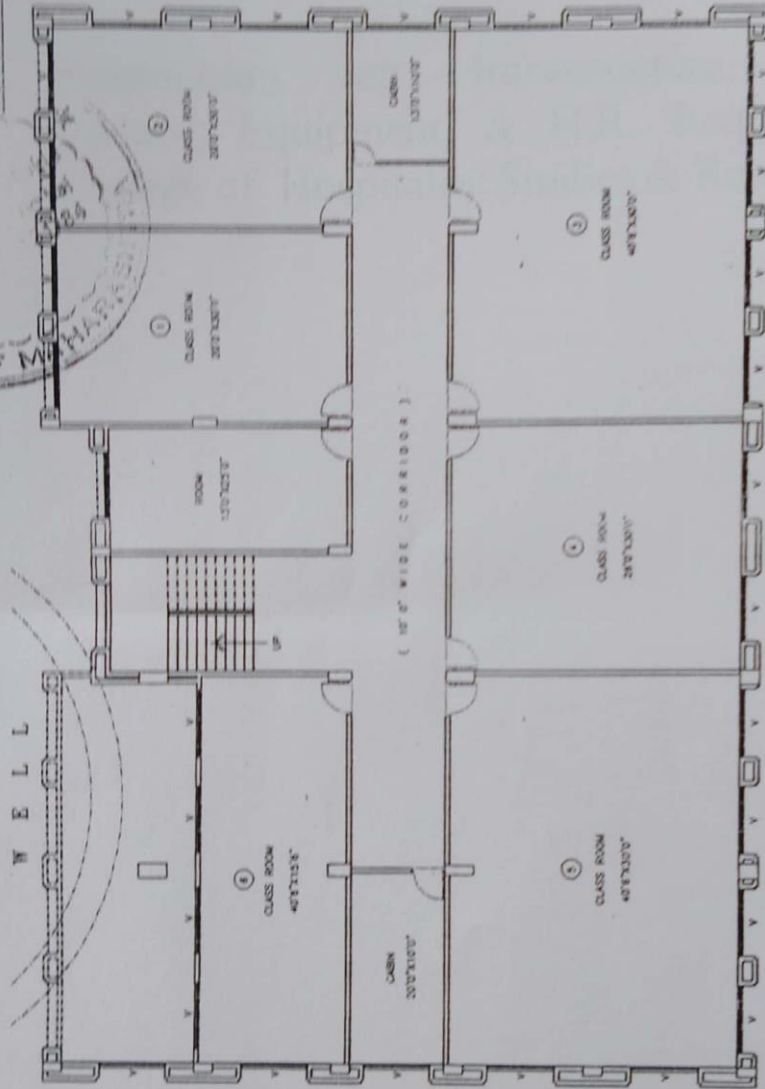

| | |
|-----------|------------|
| DATE SHRI | DATE |
| 14/09/04 | |
| SCALE | R.C.C. NO. |
| | CS-400 |
| | JOB NO. |
| | 10080/EC |

PROJECT: INTERIOR DESIGN & MAINTENANCE
 & SHOWN BLUE AZAM CAMPUS
 2390, K.B.HIDAYTULLA ROAD,
 PUNE, MAHARASHTRA
 SCALE: 1/16" = 1'-0"
 DATE: 14/09/04
 JOB NO. 10080/EC
 R.C.C. NO. CS-400

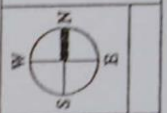

RIYAZ MULLA

PROPOSED M.C.E. SOCIETY'S INSTITUTE OF HOTEL
 MANAGEMENT AND CATERING TECHNOLOGY AT
 2390, K.B.HIDAYTULLA ROAD, AZAM CAMPUS, PUNE.



P.A. Inamdar
 President
 M.C.E. Society, Pune

ANNEXURE NO. III / IV & V

Information reg. Infrastructure, Furniture,
Fixture, Equipment, & H.R. Requirement of
College of Hospitality Studies & Research.

COLLEGE OF HOSPITALITY STUDIES & RESEARCH

Proposal for Infrastructure and H.R. Requirements

For
M.A. Rangoonwala Institute of Hotel Management and Research,
Pune.
Azam Campus, Camp Pune -411001.

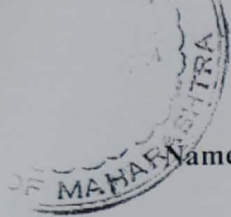

Name of the college:

M.A. Rangoonwala Institute of
Hotel Management and Research.

Affiliation:

University of Pune
(C.A/7568 dated 29/09/2006)
Government of Maharashtra.

Examining Body:

University of Pune.

College Code:

1042

Course:

Bachelor of Science – Hospitality
Studies.

Course Duration:

3 (Three) Years, Full time.

Intake:

60(Sixty)

Eligibility:

XII Pass (10+2) in any stream (Arts,
Commerce, Science, M.C.V.C) or
equivalent with minimum 45% marks
(40 % for reserved category
candidates from Maharashtra)

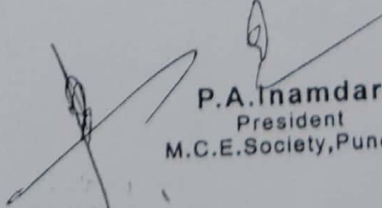

P.A. Inamdar
President
M.C.E. Society, Pune-1

INFRASTRUCUTURE REQUIRMENTS

Land Details:

Total Built-up Area required For Three Years: 30,000 Sq feet.

Requirements for the FIRST Year:

Laboratories

1. Basic Training Kitchen

| Particulars | Amount |
|--|-------------|
| 1. Equipments | |
| 2. Utensils | |
| 3. Fire extinguisher | |
| 4. Weighing Scale. | |
| 5. Exhaust System | |
| 6. Drain Channel & Drain Grating. | |
| 7. Electrical Fittings.(Fans, & Tube lights) | |
| 8. Gas Bank | |
| 9. Plumbing. | |
| Total (A1) | 14,00,000/- |



[Handwritten signature]

[Handwritten signature]
P.A. Inamdar
President
M.C.E. Society, Pune-1

2. Basic Training Restaurant.

| Particulars | Amount |
|--|------------|
| 1. Bar Counter | |
| 2. Bar Chairs | |
| 3. Restaurant Table & Chairs | |
| 4. Cutlery, Crockery & Glass Ware | |
| 5. Electrical Feetings (Fans, Tube lights and chandler) | |
| 6. Curtains & Upholstery | |
| 7. Side Stations | |
| 8. Gueridon Trolley | |
| 9. Air Conditioner | |
| 10. Music System. | |
| Total (A2) | 5,00,000/- |

P.A. Inamdar
President
M.C.E. Society, Pune-1



3. Housekeeping.

Particulars

Amount

1. Housekeeping Tables.
 2. Chairs
 3. White Board
 4. Sinks
 5. Washing Machine
 6. Vacuum Cleaner
 7. Iron & Iron Board.
 8. Chamber Maid trolley.
 9. Linen Hamper
 10. Double Bucket wringer
 11. Electrical Fittings & Fixtures.
 12. Racks
 13. Cupboards.
 14. floor polishing Machine
 15. Sewing Machine
- Total (A3)

2,00,000/-

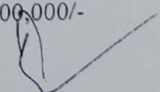
P.A. Inamdar
President
M.C.E. Society, Pune-1



4. Model Guest Room.

Particulars

Amount

1. Interior with Furniture & fixtures.

2. Television

3. Telephone

4. Minibar

5. Beds

6. Dressing Table

7. Chair

8. Sofa set

9. Writing Table

10. Luggage rack

11. Bathroom Amenities

12. Linen (Bed & Bath)

13. Decorative Accessories.

Total (A4)

3,90,000/-



A handwritten signature in black ink, appearing to be "P.A. Inamdar".

P.A. Inamdar
President
M.C.E. Society, Pune-1

5. Front Office

| Particulars | Amount |
|------------------------------------|------------|
| 1. Front Office Counter | |
| 2. Chairs | |
| 3. Telephone | |
| 4. Computer | |
| 5. Bell Desk | |
| 6. Electrical Fittings & Fixtures. | |
| 7. Maps & Clocks. | |
| Total (A5) | 2,30,000/- |

6. Computer Lab

| Particulars | Amount |
|--|------------|
| 1. 30 Computers with server/ Internet facility | |
| 2. Printer | |
| 3. Scanner | |
| 4. Projector | |
| 5. Computer Tables | |
| 6. Chairs | |
| 7. Electrical Fittings & Fixtures | |
| 8. Air conditioner | |
| 9. White Board | |
| 10. Soft board. | |
| Total (A6) | 5,00,000/- |



P.A. Inamdar
President
M.C.E. Society, Pune-1

7. Class Room.

Particulars

Amount

1. Benches
2. Green Board
3. LCD Projector.
4. Computer
5. Soft Board
6. Teachers Table & Chair

2,00,000/-

Total (A 7)

8. Girls Common Room.

Particulars

Amount

1. Lockers
2. Dresser
3. Chairs
4. Electrical Fittings

80,000/-

Total (A8)

9. Boys Common Room.

Particulars

Amount

1. Lockers
2. Dresser
3. Chairs
4. Electrical Fittings

80,000/-

Total (A9)



A handwritten signature in black ink, appearing to be "P.A. Inamdar".

P.A. Inamdar
President
M.C.E. Society, Pune-1

Requirements for the SECOND Year

Laboratories

1. Quantity Training Kitchen

| Particulars | Amount |
|--|-------------|
| 1. Equipments | |
| 2. Utensils | |
| 3. Fire extinguisher | |
| 4. Weighing Scale. | |
| 5. Exhaust System | |
| 6. Drain Channel & Drain Grating. | |
| 7. Electrical Fittings.(Fans, & Tube lights) | |
| 8. Gas Bank | |
| 9. Plumbing. | |
| 10. Civil work | |
| Total (B1) | 14,00,000/- |

2. Dining Hall

| Particulars | Amount |
|-----------------------------------|-------------|
| 1. Civil work | |
| 2. Plumbing | |
| 3. Dining table | |
| 4. Dining chairs | |
| 5. Dish washer | |
| 6. Stacking Racks | |
| 7. Plates | |
| 8. Spoons, forks & water glasses. | |
| 9. Water cooler. | |
| 10. Bain marie | |
| Total (B2) | 10,00,000/- |



10,00,000/-

P.A. Inamdar
President
M.C.E. Society, Pune-1

3. Class Room

| Particulars | Amount |
|---------------------------|------------|
| 1. Benches | |
| 2. Green Board | |
| 3. LCD Projector. | |
| 4. Computer | |
| 5. Soft Board | |
| 6. Teachers Table & Chair | |
| Total (B2) | 2,00,000/- |

4. Bakery

| Particulars | Amount |
|--|-------------|
| 1. Equipments | |
| 2. Utensils | |
| 3. Fire extinguisher | |
| 4. Weighing Scale. | |
| 5. Exhaust System | |
| 6. Drain Channel & Drain Grating. | |
| 7. Electrical Feetings.(Fans, & Tube lights) | |
| 8. Gas Bank | |
| 9. Plumbing. | |
| 10. Civil work | |
| Total (B4) | 12,00,000/- |

N.S.



P.A. Inamdar
P.A. Inamdar
President
M.C.E. Society, Pune-1

[Signature]
M.C.E. Society, Pune-1

5. Seminar Room

| Particulars | Amount |
|-------------------------------|------------|
| 1. Chairs | |
| 2. Center table | |
| 3. Podium | |
| 4. Digital class sound system | |
| 5. Computer | |
| 6. Air condition | |
| 7. Interior | |
| 8. Electrical fittings. | |
| Total (B5) | 9,00,000/- |

6. Stores

| Particulars | Amount |
|------------------------|------------|
| 1. Cupboards | |
| 2. Racks | |
| 3. Weighing scale | |
| 4. Electrical Fittings | |
| 5. Containers. | |
| 6. Fridge | |
| 7. Chest freezer | |
| Total (B6) | 3,00,000/- |

7. Lobby

| Particulars | Amount |
|-------------------------|--------------------|
| 1. Seating arrangements | |
| 2. Reception Counter | |
| Total (B7) | 2,00,000/- |
| Total | 52,00,000/- |

(B1+B2+B3+B4+B5+B6+B7)



P.A. Gramdar
President
M.C.E. Society, Pune-1

Human Resource Requirement

Teaching Staff

| | FIRST YEAR | SECOND YEAR | THIRD YEAR |
|---------------------|-------------|-------------|-------------|
| Principal | 1 | 1 | 1 |
| Professor | | | 1 |
| Assistant Professor | | 1 | 2 |
| Lecturers | 2 | 4 | 5 |
| Lectures (CNR) | 1 | 2 | 2 |
| Salary Per | 10,80,000/- | 19,20,000/- | 30,00,000/- |

Non - Teaching Staff :

| | FIRST YEAR | SECOND YEAR | THIRD YEAR |
|-----------------|------------|-------------|-------------|
| Librarian | 1 | 1 | 1 |
| Accountant | 1 | 1 | 1 |
| Clerk | 1 | 1 | 1 |
| Peons | 2 | 2 | 2 |
| Lab Attendants | 3 | 4 | 5 |
| Sweepers | 2 | 4 | 5 |
| Salary Per Year | 8,83,000/- | 11,00,000/- | 13,00,000/- |

Salaries of Teaching & non Teaching Staff :

| | |
|-------------|-------------|
| FIRST YEAR | 19,63,000/- |
| SECOND YEAR | 30,20,000/- |
| THIRD YEAR | 43,00,000/- |

Total Expenditure:

| | |
|-------------|-------------|
| FIRST YEAR | 87,73,000/- |
| SECOND YEAR | 82,20,000/- |
| THIRD YEAR | 60,00,000/- |

Total: 2,29,93,000/-

(Total in SUSD @ 40.00 Rs) S 5, 74,825/- USD



(Handwritten signature)

P.A. Inamdar
President
M.C.E. Society, Pune-1

Recommendation Letters from
M.A.Rangoonwala Foundation (India) Trust
towards the 3 Year Program in
B.Sc. Hospitality Studies

June 29, 2018

Dr. P.A. Inamdar
President
Maharashtra Cosmopolitan Education Society
2390-B, K.B. Hidayatullah Road
Camp, Pune- 411 001

Dear Dr. Inamdar,

Greetings!

Following are the details of students recommended for Hotel Management course at M. A. Rangoonwala Institute of Hotel Management & Research, Pune by us

We are directing them to the Institute to complete admission formalities.

| No. | Name | Remarks |
|-----|----------------------|--|
| 1 | Ms. Ankita Devghakar | Has completed admission formalities. Thank you for sanctioning concession in Hostel fees. Academic Year starting July 2018 |
| 2 | Mr. Altaf Shaikh | Academic Year starting July 2018 |
| 3 | Mr. Geetesh Bhosale | Academic Year starting July 2018 |
| 4 | Mr. Zahid Dafedar | Year 2 Student. Kindly consider him as RF(I)T student from Year 1 and adjust his fees accordingly. |

They will be eligible for concessional fees of Rs. 15,000 per year as per our Agreement with you.

We request you to do the needful to facilitate the admission process and related formalities.

Thanking you,
With regards,

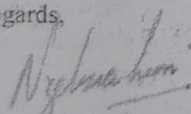

Nisreen Ebrahim
CEO

CC to : Dr. Anita Frantz

Rangoonwala Foundation (India) Trust

Office Address : 85, Atlanta, Nariman Point, Mumbai - 400 021.

Tel : +91-22-6661 2553 / 63 • Fax : +91-22-6632 1978 • E-mail : assist@rangoonwala.org

Web: www.rangoonwala.org

Rangoonwala Foundation (India) Trust

Trust Reg. No.: E-20860 - Mumbai

July 10, 2015

Shaikh Mohammad Danish
K/3, Colaba Plot, Jhulo Maidan,
Sirojuddin Chawl,
Room No-24,
Near Jannat Hotel,
Jogeshwari (E),
Mumbai-60

Subject: Recommendation Letter towards the 3 year course in Hotel Management for the academic year starting 2015-2016 at M. A. Rangoonwala Institute of Hotel Management & Research, Pune.

Dear Danish,

Congratulations!

In response to your application to us, your name has been recommended by the Rangoonwala Foundation (India) Trust for 3 year Hotel Management course at the above Institute.

I hope you will make the best of this opportunity, and use your training in the service towards society in future.

As conveyed to you already, you are required to get in touch with the M.A. Rangoonwala Institute of Hotel Management & Research, Pune, to proceed with further formalities pertaining to your admission. You may carry this letter with you to facilitate the process.

You will have to:

1. Send us a letter of confirmation of your having taken the seat and undertaking that you will complete the course to its full term and requirements.
2. You are requested to contribute Rs. 15,000/- per year (Rs. Fifteen Thousand only) towards your tuition fees to the Institute. Please send us a copy of the fee receipt **every year** for our records.
3. Provide your e-mail contact and also update any change in contact information- address, phone numbers on a concurrent basis.
4. Information sharing should be done on e-mail to us at: assist@rangoonwala.org
5. It is compulsory for you to join the RF(I)T's student's e-group (rfithgmaet@googlegroups.com) We will send you a link for this and you will have to accept the e-invitation within 3 days and send us an e-mail, confirming that you have done so.

Office Address : 85, Atlanta, Nariman Point, Mumbai - 400 021.
Tel : +91-22-6661 2553 / 63 • Fax : +91-22-6632 1978 • E-mail : assist@rangoonwala.org
Web: www.rangoonwala.org

6. For every exam (internal and external) you are required to submit your **exam schedule and results** as proof of your performance to the Trust as soon as they are available to you. If mark sheets will be made available at a later date, results should be conveyed on e-mail.
7. You will be called upon to volunteer for our activities and programmes for a minimum of **10 days** in an academic year on pre-decided, mutually convenient dates.
8. Participation in RF(I)T program's is compulsory.
9. You are required to abide by the terms and conditions of RF(I)T's scholarship scheme as specified herein or as it may change at any time in the future.

We will be in touch with the Institute to monitor your performance. You will have to be regular in your attendance and your studies and not get into any questionable disciplinary issues.

RF(I)T reserves the right to withdraw the scholarship if your academic performance is not up to the mark or it comes to our knowledge that you have falsely declared or not declared facts pertaining to your application to us.

Non-compliance to RF(I)T norms as they exist now or in the future, will lead not only to the withdrawal of RF concessional seat benefit, but you will have to reimburse us the expenses incurred on your behalf, in case you leave the course mid-way or for any other issues that cannot be amicably resolved with us.

As per RF(I)T's revised norm, you will be required to submit post-dated cheque, every year, equal to the actual college fees (at present Rs. 70000/-) in our favor as a guarantee from you to adhere to RF(I)T norms. This cheque will be encashed only if you do not complete your compliance or else it will be returned to you after we verify your documents/ compliances for each academic year (*As per Section 138 of Negotiable Instruments Act, 1881, Dishonor of Cheque is deemed as an offence and judicial proceedings shall be initiated.*)

Kindly sign the second copy of this letter as token of acceptance of the terms and conditions stated above.

In case of any further queries, please feel free to contact us or Mr. P.A. Inamdar at the Pune Institute.

On behalf of the Trustees of the Foundation, I wish you the very best in your chosen career.

Regards and best wishes,

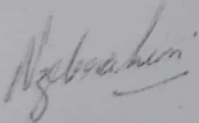

Nisreen Ebrahim
CEO

Rangoonwala Foundation (India) Trust

Office Address : 85, Atlanta, Nariman Point, Mumbai - 400 021.
Tel : +91-22-6661 2553 / 63 • Fax : +91-22-6632 1978 • E-mail : assist@rangoonwala.org
Web: www.rangoonwala.org

Rangoonwala Foundation (India) Trust

Trust Reg. No.: E-20860 - Mumbai

July 06, 2017

Saad Shafi Shaikh
S.No65/5, Kedari Nagar,
Salunkhe Vihar Road,
Pune 411040

Subject: Recommendation Letter towards the 3 year course in Hotel Management for the academic year starting 2017-2018 at 'M. A. Rangoonwala Institute of Hotel Management & Research', Pune.

Dear Saad,

Congratulations!

In response to your application to us, your name has been recommended by the Rangoonwala Foundation (India) Trust for 3 year Hotel Management course at the above Institute.

I hope you will make the best of this opportunity, and use your training in the service towards society in future.

As conveyed to you already, you are required to get in touch with the M.A. Rangoonwala Institute of Hotel Management & Research, Pune, to proceed with further formalities pertaining to your admission. You may carry this letter with you to facilitate the process.

You will have to:

1. Send us a letter of confirmation of your having taken the seat and undertaking that you will complete the course to its full term and requirements.
2. You are requested to contribute Rs. 15,000/- per year (Rs. Fifteen Thousand only) towards your tuition fees to the Institute. Please send us a copy of the fee receipt **every year** for our records.
3. Provide your e-mail contact and also update any change in contact information- address, phone numbers on a concurrent basis.
4. Information sharing should be done on e-mail to us at: assist@rangoonwala.org
5. It is compulsory for you to join the RF(I)T's student's e-group (rfithgmaet@googlegroups.com) We will send you a link for this and you will have to accept the e-invitation within 3 days and send us an e-mail, confirming that you have done so.
6. For every exam (internal and external) you are required to submit your **exam schedule and results** as proof of your performance to the Trust as soon as they are available to you. If mark sheets will be made available at a later date, results should be conveyed on e-mail.

Office Address : 85, Atlanta, Nariman Point, Mumbai - 400 021.
Tel : +91-22-6661 2553 / 63 • Fax : +91-22-6632 1978 • E-mail : assist@rangoonwala.org
Web: www.rangoonwala.org

7. You will be called upon to volunteer for our activities and programmes for a minimum of **10 days** in an academic year on pre-decided, mutually convenient dates.
8. Participation in RF(I)T program's is compulsory.
9. You are required to abide by the terms and conditions of RF(I)T's scholarship scheme as specified herein or as it may change at any time in the future.

We will be in touch with the Institute to monitor your performance. You will have to be regular in your attendance and your studies and not get into any questionable disciplinary issues.

RF(I)T reserves the right to withdraw the scholarship if your academic performance is not up to the mark or it comes to our knowledge that you have falsely declared or not declared facts pertaining to your application to us.

Non-compliance to RF(I)T norms as they exist now or in the future, will lead not only to the withdrawal of RF concessional seat benefit, but you will have to reimburse us the expenses incurred on your behalf, in case you leave the course mid-way or for any other issues that cannot be amicably resolved with us.

As per RF(I)T's revised norm, you will be required to submit post-dated cheque, every year, equal to the actual college fees (at present Rs. 70,000/-) in our favor as a guarantee from you to adhere to RF(I)T norms. This cheque will be encashed only if you do not complete your compliance or else it will be returned to you after we verify your documents/ compliances for each academic year (*As per Section 138 of Negotiable Instruments Act, 1881, Dishonor of Cheque is deemed as an offence and judicial proceedings shall be initiated.*)

Kindly sign the second copy of this letter as token of acceptance of the terms and conditions stated above.

In case of any further queries, please feel free to contact us or Mr. P.A. Inamdar at the Pune Institute.

On behalf of the Trustees of the Foundation, I wish you the very best in your chosen career.

Regards and best wishes,

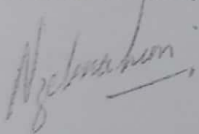

Nisreen Ebrahim
CEO

Rangoonwala Foundation (India) Trust

Office Address : 85, Atlanta, Nariman Point, Mumbai - 400 021.

Tel : +91-22-6661 2553 / 63 • Fax : +91-22-6632 1978 • E-mail : assist@rangoonwala.org

Web: www.rangoonwala.org